

Verdieping

← 2.20 m → ← 3.25 m →

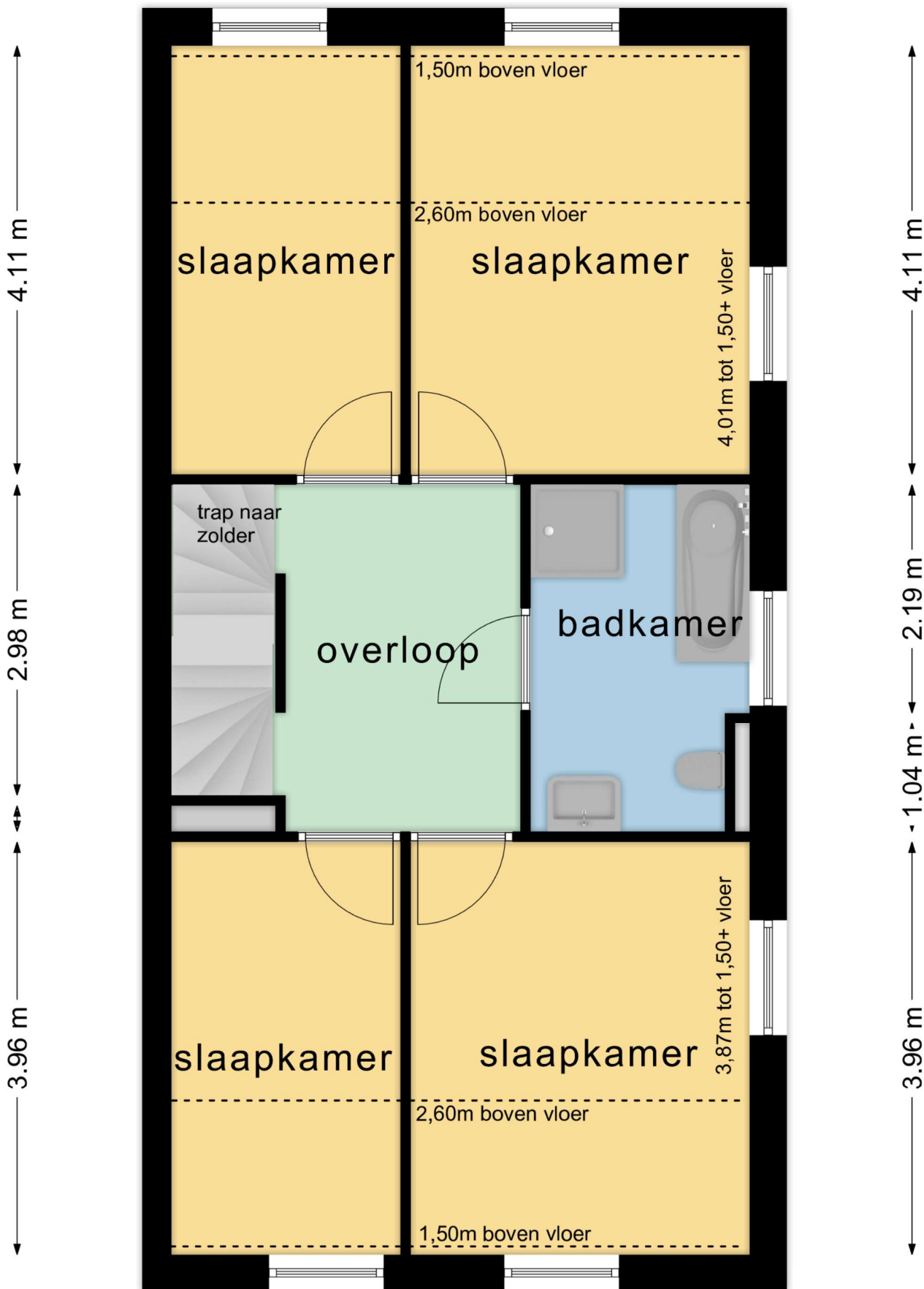

← 2.20 m → ← 3.25 m →

Zolder
5.55 m



4.11 m
2.98 m
3.96 m

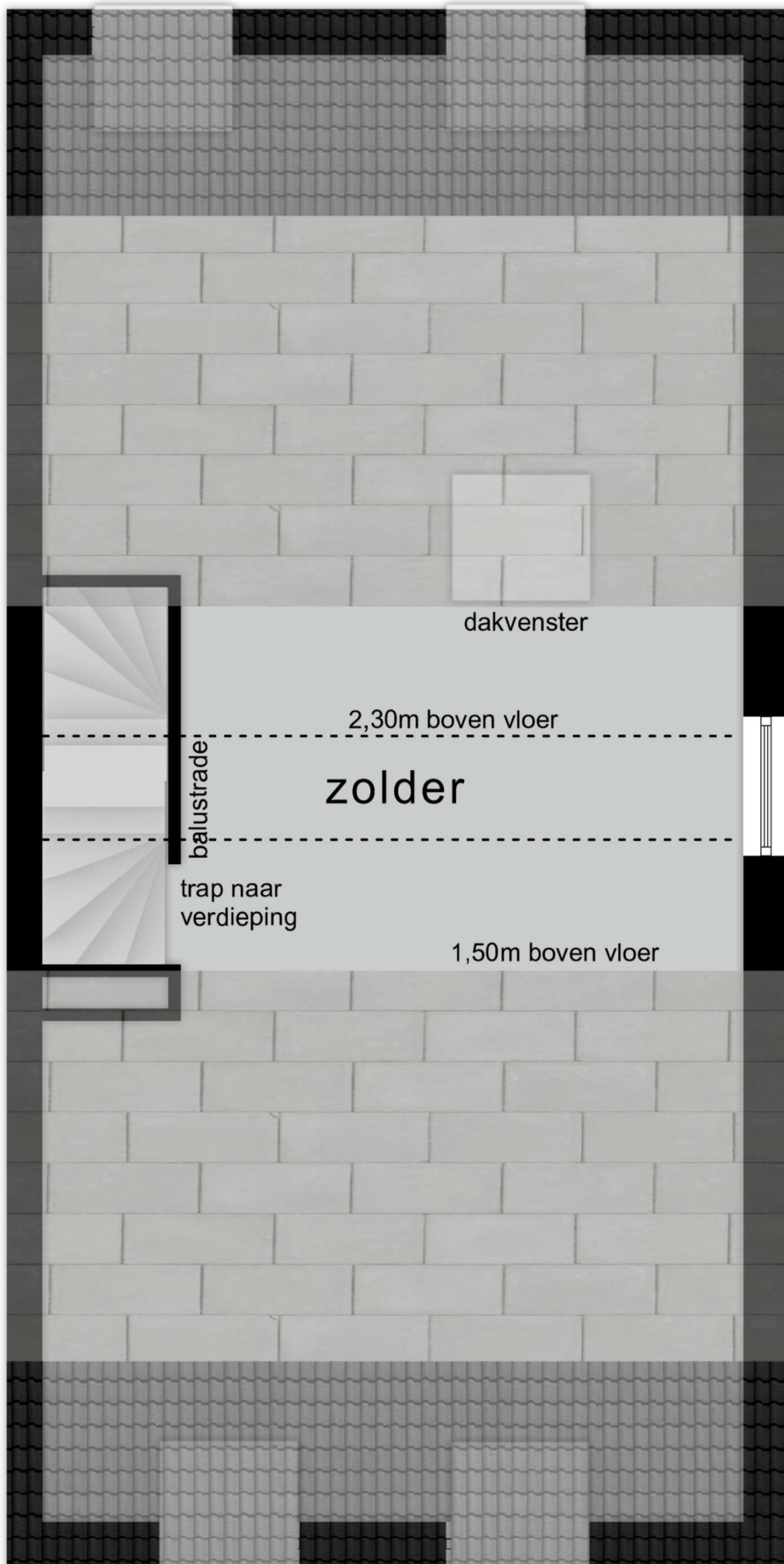

dakvenster

2,30m boven vloer

zolder

balustrade

trap naar
verdieping

1,50m boven vloer

11.60 m



5.55 m

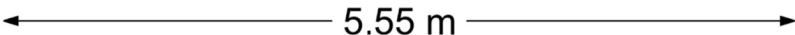

Berging
5.60 m

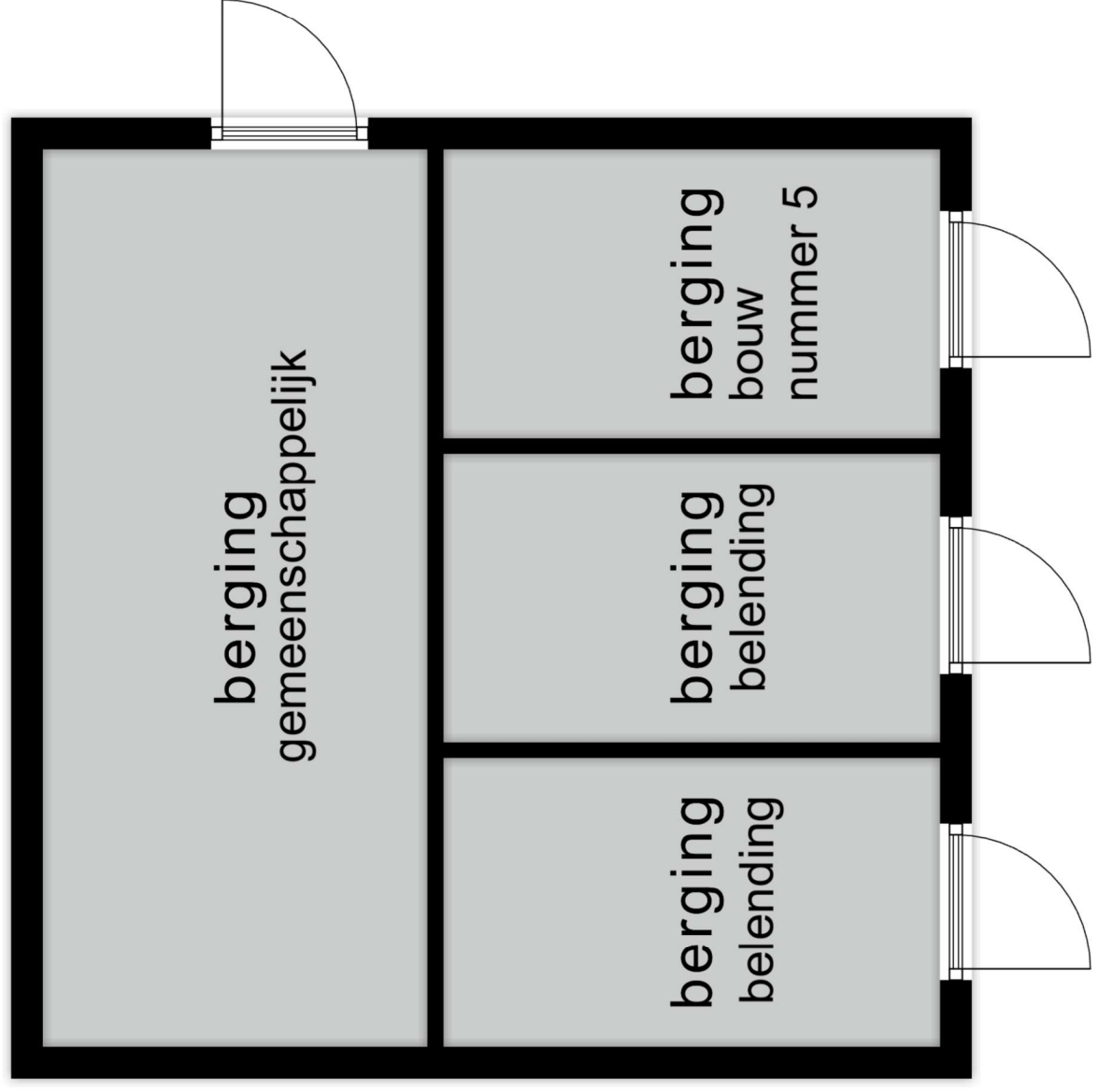

3.10 m
2.40 m

1.80 m
1.80 m
1.80 m

3.10 m
2.40 m